



THE CASTILLO - C at NOCATEE



THE CASTILLO - WEST INDIES

MODEL

3 Bedrooms • 2.5 Bathrooms • 2-Car Garage • 1,680 ft² Living Area • 2,306 ft² Under Roof

The Castillo is a stylish two-story townhome featuring 3 bedrooms, 2.5 baths, and a two-car garage within its 1,680 square feet. The open-concept main floor combines a modern kitchen, dining, and living area, ideal for both entertaining and daily comfort. Upstairs, the private master suite includes a balcony, walk-in closet, and dual-vanity bath. Two additional bedrooms share a full bath, and a central laundry room adds convenience. With quality craftsmanship and options for customization, the Castillo offers a blend of style, practicality, and comfort designed for modern living.

* Renderings may vary from actual home. Please see disclaimer for more details.

\$2,651

ESTIMATED SAVINGS



This home has a HERS Score of 64 and is estimated to save you \$2,651 on your annual utility bills vs. a resale home.

THE CASTILLO - C

3 Bedrooms • 2.5 Bathrooms • 2-Car Garage

MODEL

Nocatee
Townhome Series | West End - Lot 53
469 Crestview Drive
Ponte Vedra, FL, 32081

Living Area: 1,680 ft²

Priced at: \$510,065

FIRST-SECOND FLOOR

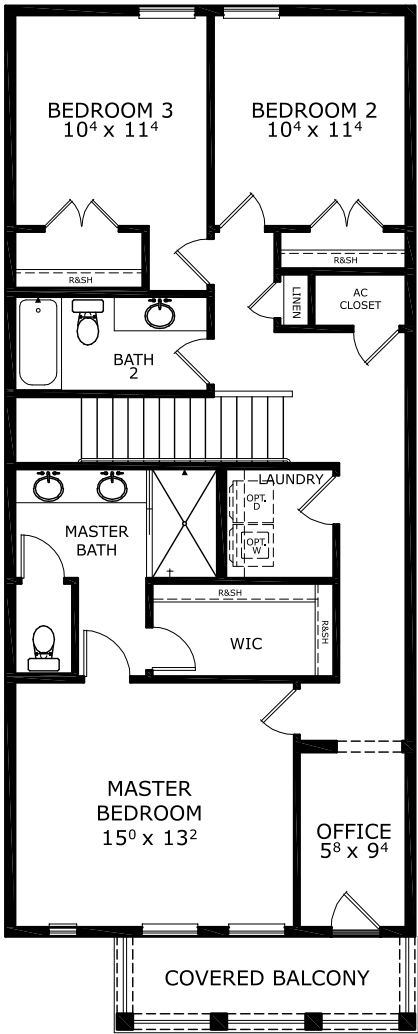
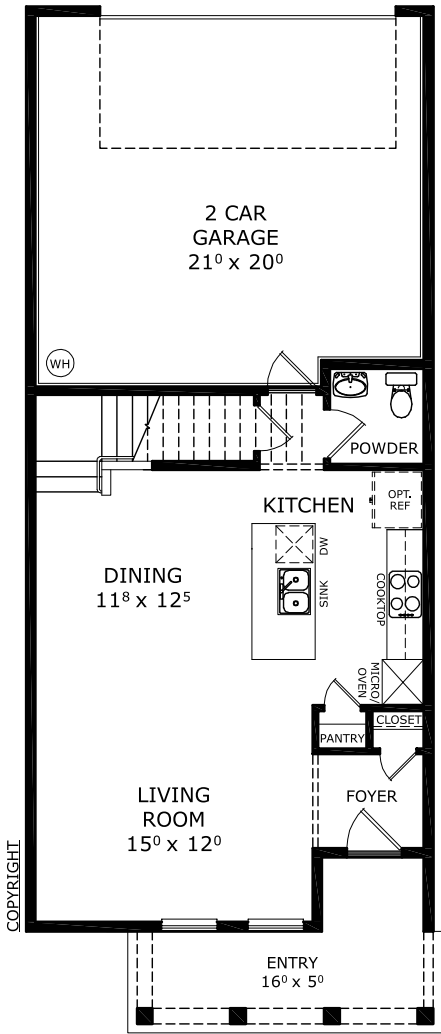

This Castillo - C is a Model! [Speak to a Sales Counselor \(844\) 349-6401](#) or visit [ICIHomes.com](#)

©1994-2026 ICI Homes™ is a registered trademark whose divisions operate under . Features may be plan specific and vary. Please consult a Sales Associate for specific feature information. All new ICI Homes come with a HBW 2-10 warranty. Certain elevations may have additional fees. Prices may not include lot premiums, upgrades, and options. Inventory home completion date may vary. All prices subject to change without notice. All plans are property of ICI Homes and cannot be copied or used without permission. Prices, promotions, incentives, features, options, amenities, floor plans, elevations, site maps, designs, materials, and dimensions are for illustrative purposes only and subject to change without notice. Plans should not be relied upon as representation express or implied of final sizes, locations, features or dimensions. Square footage and dimensions are estimated and may vary from description. All HERS ratings and savings are calculated by a third party energy rating service. Actual savings will depend on a number of factors, including but not limited to daily activities, home maintenance practices, household size, use of appliances, lighting and internal climate control systems, lot orientation, and surrounding climate and weather conditions. Created on 01/23/2026: _____ Garage Orientation R / L: _____

